

ORCHARDS GREEN

117TH & FOURTH PLAIN BLVD. • VANCOUVER • WA



PROPERTY HIGHLIGHTS

- 5,500 SF (Divisible)
- Great End-cap location
- Pylon signage available
- Centrally located in Orchards trade area

SURROUNDING RETAILERS:



DEMOGRAPHICS

	1 MILE	3 MILES	5 MILES
2014 POPULATION	13,589	106,350	218,249
2014 AVG. HH INCOME	\$52,026	\$67,032	\$67,766
2014 DAYTIME POPULATION	6,129	42,731	81,096

CONTACT



BROCK SWITZER
503-245-1400 EXT 518 • BROCK@HSMPCIFIC.COM

KARA PHELPS
503-245-1400 EXT 515 • KARA@HSMPCIFIC.COM



HSM Pacific Realty, Inc.
0612 SW Idaho St, Suite 2
Portland, OR 97239
www.hsmacific.com

ORCHARDS GREEN

117TH & FOURTH PLAIN BLVD. · VANCOUVER · WA

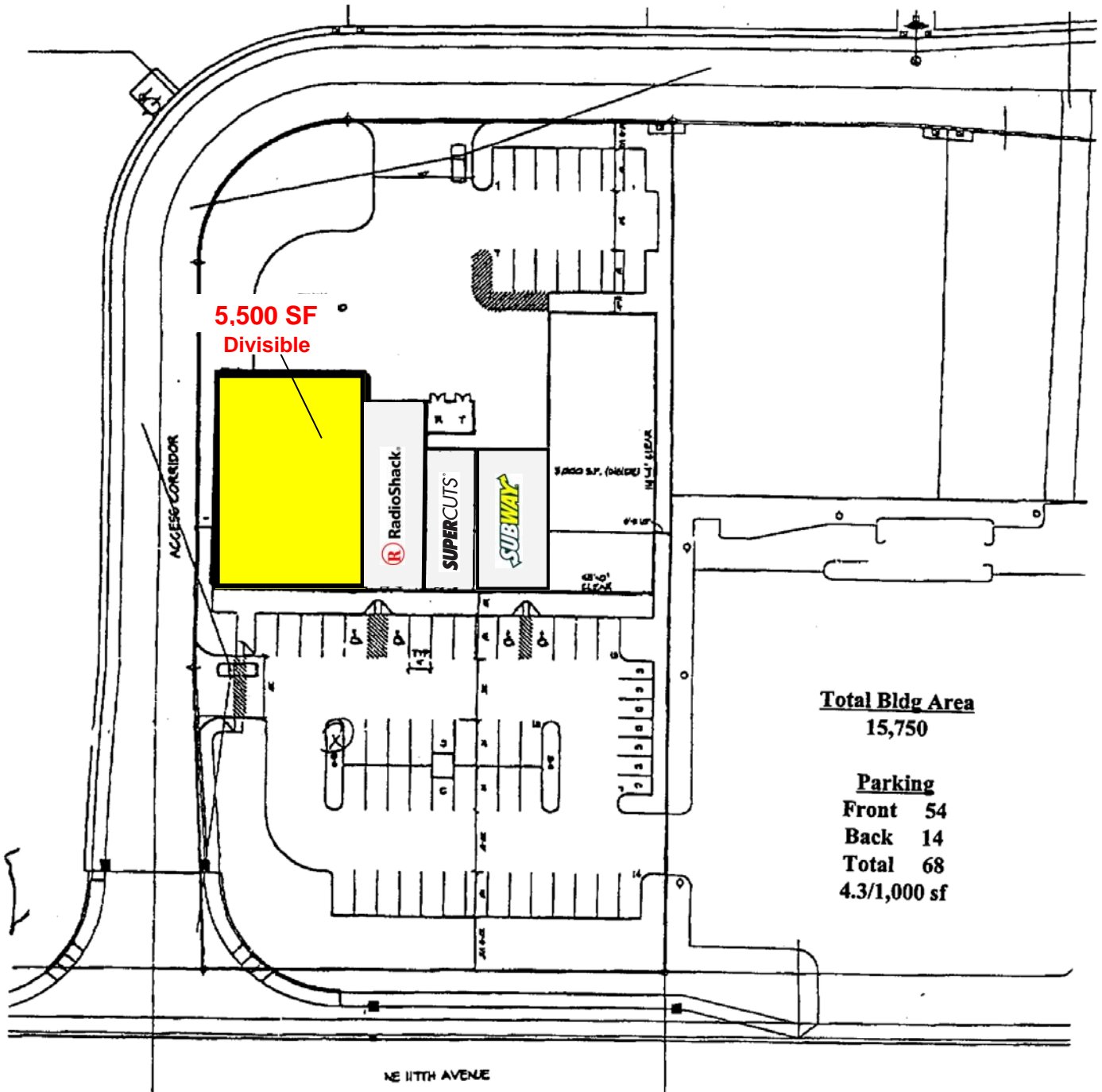

CONTACT



BROCK SWITZER
503-245-1400 EXT 518 · BROCK@HSPACIFIC.COM

KARA PHELPS
503-245-1400 EXT 515 · KARA@HSPACIFIC.COM



HSM Pacific Realty, Inc.
0612 SW Idaho St, Suite 2
Portland, OR 97239
www.hspacific.com

ORCHARDS GREEN

117TH & FOURTH PLAIN BLVD. • VANCOUVER • WA



CONTACT



BROCK SWITZER
503-245-1400 EXT 518 • BROCK@HSPACIFIC.COM

KARA PHELPS
503-245-1400 EXT 515 • KARA@HSPACIFIC.COM



HSM Pacific Realty, Inc.
0612 SW Idaho St, Suite 2
Portland, OR 97239
www.hspacific.com

FULL PROFILE

2000-2010 Census, 2014 Estimates with 2019 Projections

Calculated using Proportional Block Groups



Lat/Lon: 45.6673/-122.5526

RF1

NE 117th Ave & NE Fourth Plain Blvd

Vancouver, WA

		1 Mile	3 Miles	5 Miles
POPULATION	2014 Estimated Population	13,589	106,350	218,249
	2019 Projected Population	14,191	111,067	227,920
	2010 Census Population	13,207	103,354	212,106
	2000 Census Population	10,275	82,248	177,497
	Projected Annual Growth 2014 to 2019	0.9%	0.9%	0.9%
	Historical Annual Growth 2000 to 2014	2.3%	2.1%	1.6%
HOUSEHOLDS	2014 Estimated Households	5,064	38,638	82,353
	2019 Projected Households	5,324	40,618	86,576
	2010 Census Households	4,905	37,427	79,768
	2000 Census Households	3,838	29,071	65,699
	Projected Annual Growth 2014 to 2019	1.0%	1.0%	1.0%
	Historical Annual Growth 2000 to 2014	2.3%	2.4%	1.8%
AGE	2014 Est. Population Under 10 Years	15.1%	14.4%	13.7%
	2014 Est. Population 10 to 19 Years	14.6%	14.7%	14.0%
	2014 Est. Population 20 to 29 Years	16.2%	14.4%	13.9%
	2014 Est. Population 30 to 44 Years	20.8%	21.0%	20.3%
	2014 Est. Population 45 to 59 Years	17.3%	18.7%	19.4%
	2014 Est. Population 60 to 74 Years	12.0%	12.2%	13.3%
	2014 Est. Population 75 Years or Over	4.0%	4.7%	5.5%
	2014 Est. Median Age	32.1	34.0	35.8
MARITAL STATUS & GENDER	2014 Est. Male Population	48.5%	48.9%	49.0%
	2014 Est. Female Population	51.5%	51.1%	51.0%
	2014 Est. Never Married	31.4%	29.0%	29.0%
	2014 Est. Now Married	42.8%	49.0%	48.4%
	2014 Est. Separated or Divorced	21.6%	17.2%	17.6%
	2014 Est. Widowed	4.3%	4.9%	5.1%
INCOME	2014 Est. HH Income \$200,000 or More	0.5%	2.1%	2.6%
	2014 Est. HH Income \$150,000 to \$199,999	1.9%	3.9%	4.2%
	2014 Est. HH Income \$100,000 to \$149,999	6.0%	12.4%	12.7%
	2014 Est. HH Income \$75,000 to \$99,999	12.3%	16.8%	15.1%
	2014 Est. HH Income \$50,000 to \$74,999	27.8%	24.9%	22.3%
	2014 Est. HH Income \$35,000 to \$49,999	19.5%	15.2%	15.2%
	2014 Est. HH Income \$25,000 to \$34,999	12.0%	9.2%	10.0%
	2014 Est. HH Income \$15,000 to \$24,999	10.8%	8.5%	9.3%
	2014 Est. HH Income Under \$15,000	9.2%	7.0%	8.5%
	2014 Est. Average Household Income	\$52,026	\$67,032	\$67,766
	2014 Est. Median Household Income	\$49,171	\$61,314	\$59,227
	2014 Est. Per Capita Income	\$19,455	\$24,417	\$25,643
2014 Est. Total Businesses	661	3,836	8,523	
2014 Est. Total Employees	6,129	42,731	81,096	

This report was produced using data from private and government sources deemed to be reliable. The information herein is provided without representation or warranty.

FULL PROFILE

2000-2010 Census, 2014 Estimates with 2019 Projections

Calculated using Proportional Block Groups



Lat/Lon: 45.6673/-122.5526

RF1

NE 117th Ave & NE Fourth Plain Blvd		1 Mile	3 Miles	5 Miles
Vancouver, WA				
RACE	2014 Est. White	80.5%	82.5%	82.2%
	2014 Est. Black	2.8%	2.6%	2.7%
	2014 Est. Asian or Pacific Islander	5.7%	5.8%	5.8%
	2014 Est. American Indian or Alaska Native	1.2%	0.9%	0.9%
	2014 Est. Other Races	9.8%	8.3%	8.4%
HISPANIC	2014 Est. Hispanic Population	1,647	10,396	22,659
	2014 Est. Hispanic Population	12.1%	9.8%	10.4%
	2019 Proj. Hispanic Population	13.0%	10.5%	11.1%
	2010 Hispanic Population	11.1%	9.0%	9.5%
EDUCATION (Adults 25 or Older)	2014 Est. Adult Population (25 Years or Over)	8,413	67,342	141,601
	2014 Est. Elementary (Grade Level 0 to 8)	3.7%	2.9%	3.2%
	2014 Est. Some High School (Grade Level 9 to 11)	11.7%	7.9%	7.3%
	2014 Est. High School Graduate	33.7%	28.2%	27.4%
	2014 Est. Some College	29.2%	32.2%	30.9%
	2014 Est. Associate Degree Only	8.8%	9.3%	9.8%
	2014 Est. Bachelor Degree Only	9.7%	13.2%	14.4%
	2014 Est. Graduate Degree	3.3%	6.2%	7.1%
HOUSING	2014 Est. Total Housing Units	5,323	40,026	85,535
	2014 Est. Owner-Occupied	50.8%	59.8%	57.4%
	2014 Est. Renter-Occupied	44.3%	36.7%	38.8%
	2014 Est. Vacant Housing	4.9%	3.5%	3.7%
HOMES BUILT BY YEAR	2010 Homes Built 2005 or later	9.3%	11.3%	8.9%
	2010 Homes Built 2000 to 2004	12.6%	11.2%	10.1%
	2010 Homes Built 1990 to 1999	28.0%	26.5%	23.4%
	2010 Homes Built 1980 to 1989	14.9%	13.5%	14.1%
	2010 Homes Built 1970 to 1979	19.0%	20.1%	20.7%
	2010 Homes Built 1960 to 1969	6.2%	7.0%	8.7%
	2010 Homes Built 1950 to 1959	3.9%	3.8%	5.7%
	2010 Homes Built Before 1949	6.3%	6.7%	8.5%
HOME VALUES	2010 Home Value \$1,000,000 or More	0.5%	0.6%	0.9%
	2010 Home Value \$500,000 to \$999,999	3.7%	4.3%	5.7%
	2010 Home Value \$400,000 to \$499,999	3.7%	4.4%	6.1%
	2010 Home Value \$300,000 to \$399,999	8.3%	11.5%	14.2%
	2010 Home Value \$200,000 to \$299,999	33.1%	45.2%	41.9%
	2010 Home Value \$150,000 to \$199,999	20.7%	21.8%	19.0%
	2010 Home Value \$100,000 to \$149,999	10.9%	6.2%	5.8%
	2010 Home Value \$50,000 to \$99,999	7.6%	2.5%	2.4%
	2010 Home Value \$25,000 to \$49,999	3.1%	0.9%	1.1%
	2010 Home Value Under \$25,000	8.2%	2.6%	3.0%
	2010 Median Home Value	\$190,083	\$229,323	\$245,709
	2010 Median Rent	\$775	\$877	\$812

This report was produced using data from private and government sources deemed to be reliable. The information herein is provided without representation or warranty.

FULL PROFILE

2000-2010 Census, 2014 Estimates with 2019 Projections

Calculated using Proportional Block Groups



Lat/Lon: 45.6673/-122.5526

RF1

NE 117th Ave & NE Fourth Plain Blvd

Vancouver, WA

		1 Mile	3 Miles	5 Miles
LABOR FORCE	2014 Est. Labor Population Age 16 Years or Over	10,261	80,937	168,556
	2014 Est. Civilian Employed	61.5%	61.7%	60.9%
	2014 Est. Civilian Unemployed	6.0%	5.9%	5.7%
	2014 Est. in Armed Forces	0.4%	0.3%	0.2%
	2014 Est. not in Labor Force	32.1%	32.1%	33.2%
	2014 Labor Force Males	47.6%	48.3%	48.5%
	2014 Labor Force Females	52.4%	51.7%	51.5%
OCCUPATION	2010 Occupation: Population Age 16 Years or Over	5,596	46,084	95,148
	2010 Mgmt, Business, & Financial Operations	8.5%	11.6%	12.6%
	2010 Professional, Related	12.9%	18.4%	19.0%
	2010 Service	21.2%	17.0%	17.6%
	2010 Sales, Office	26.0%	26.8%	26.2%
	2010 Farming, Fishing, Forestry	0.2%	0.3%	0.4%
	2010 Construction, Extraction, Maintenance	11.1%	9.0%	8.4%
	2010 Production, Transport, Material Moving	20.0%	16.8%	15.7%
	2010 White Collar Workers	47.4%	56.9%	57.8%
	2010 Blue Collar Workers	52.6%	43.1%	42.2%
TRANSPORTATION TO WORK	2010 Drive to Work Alone	74.8%	79.0%	78.3%
	2010 Drive to Work in Carpool	14.0%	10.3%	10.2%
	2010 Travel to Work by Public Transportation	3.5%	2.9%	2.9%
	2010 Drive to Work on Motorcycle	0.2%	0.2%	0.2%
	2010 Walk or Bicycle to Work	1.8%	1.9%	2.2%
	2010 Other Means	2.0%	1.0%	1.1%
	2010 Work at Home	3.7%	4.7%	5.2%
TRAVEL TIME	2010 Travel to Work in 14 Minutes or Less	27.0%	25.8%	27.6%
	2010 Travel to Work in 15 to 29 Minutes	41.2%	43.1%	42.2%
	2010 Travel to Work in 30 to 59 Minutes	26.7%	25.6%	25.1%
	2010 Travel to Work in 60 Minutes or More	5.0%	5.5%	5.1%
	2010 Average Travel Time to Work	21.2	21.1	20.4
CONSUMER EXPENDITURE	2014 Est. Total Household Expenditure	\$227 M	\$2.06 B	\$4.41 B
	2014 Est. Apparel	\$10.9 M	\$99.0 M	\$212 M
	2014 Est. Contributions, Gifts	\$13.2 M	\$128 M	\$278 M
	2014 Est. Education, Reading	\$5.62 M	\$54.8 M	\$119 M
	2014 Est. Entertainment	\$12.6 M	\$115 M	\$247 M
	2014 Est. Food, Beverages, Tobacco	\$37.3 M	\$330 M	\$706 M
	2014 Est. Furnishings, Equipment	\$9.65 M	\$90.6 M	\$194 M
	2014 Est. Health Care, Insurance	\$16.5 M	\$146 M	\$314 M
	2014 Est. Household Operations, Shelter, Utilities	\$67.5 M	\$613 M	\$1.32 B
	2014 Est. Miscellaneous Expenses	\$3.89 M	\$34.4 M	\$73.7 M
	2014 Est. Personal Care	\$3.32 M	\$29.9 M	\$64.0 M
2014 Est. Transportation	\$46.6 M	\$419 M	\$890 M	

This report was produced using data from private and government sources deemed to be reliable. The information herein is provided without representation or warranty.