

OAK HILLS VILLAGE

14740 NW CORNELL RD. · PORTLAND · OR



PROPERTY HIGHLIGHTS

- Available: 1,062 SF / 1,260 SF / 1,401 SF / 1,450 SF
- \$28.00/NNN
- Located off Highway 26 in popular Sunset Corridor
- The center is near Cornell Oaks Corporate Park, Sunset High School, affluent Oak Hills and Bethany neighborhoods.
- Traffic count 23,608 ADT

DEMOGRAPHICS

	1 MILE	3 MILES	5 MILES
2025 POPULATION	13,462	150,021	295,881
2025 AVG. HH INCOME	\$176,036	\$160,990	\$153,126
2025 DAYTIME POPULATION	5,963	52,724	109,316

CONTACT:

DOUG MAGNUSEN doug@hsmpacific.com 503.245.1400 x516



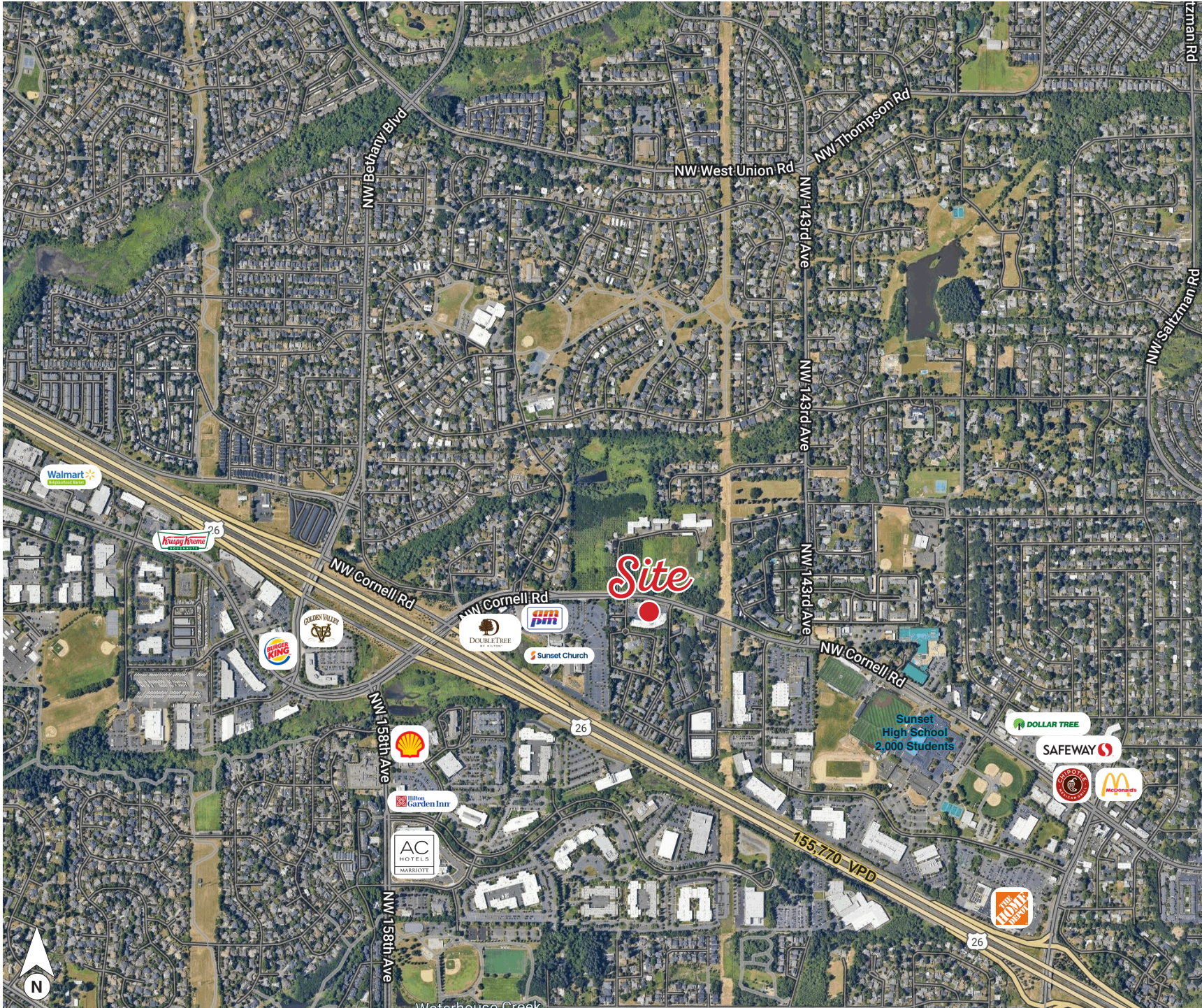

Site

Walmart

Kroger

Burger King

Golden Valley

DoubleTree

Sun

Sunset Church

Shell

Hilton Garden Inn

AC Hotels
MARRIOTT

Sunset High School
2,000 Students

DOLLAR TREE

SAFeway

McDonald's

McDonald's

THE HOME DEPOT

NW Bethany Blvd

NW West Union Rd

NW Thompson Rd

NW 143rd Ave

NW 143rd Ave

NW 143rd Ave

NW Cornell Rd

NW Cornell Rd

NW Cornell Rd

NW 158th Ave

NW 158th Ave

NW Saltzman Rd

Saltzman Rd

26

26

26

155,770 VPD



Waterhouse Creek

OAK HILLS VILLAGE

14740 NW CORNELL RD. · PORTLAND · OR



OAK HILLS VILLAGE

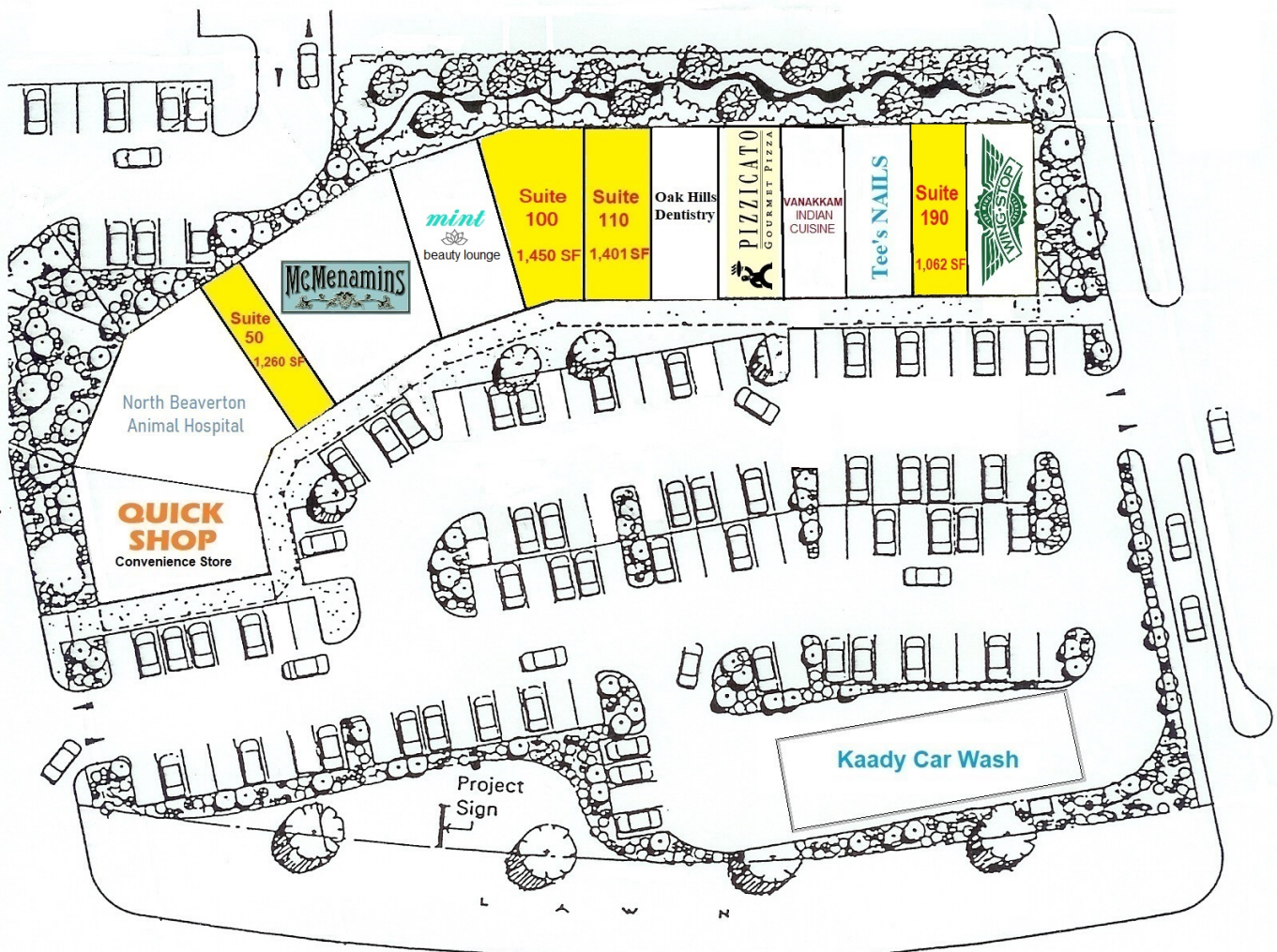

14740 NW Cornell Road

CONTACT:

DOUG MAGNUSEN doug@hsmPacific.com 503.245.1400 x516

